

# PISA2<sup>®</sup> / ROMAN PISA<sup>®</sup>

## GRAVITY WALL W/ WOOD PRIVACY FENCE

REF: Detail\_Pisa2\_Roman Pisa\_Wood Fence on Top of Gravity Wall

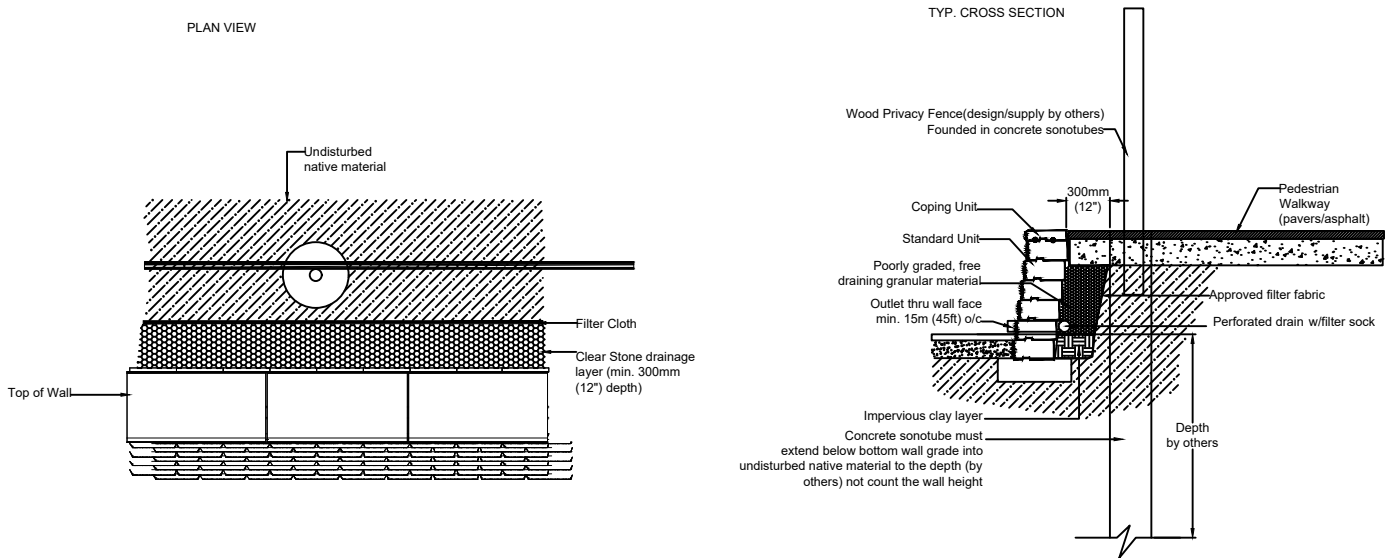

### Notes

1. Concrete sonotube must extend below bottom wall grade into undisturbed native material to the depth (by others) not count the wall height
2. Sonotubes must be placed as retaining wall is constructed.



Engineering design by RisiStone Inc.

UNILOCK.COM | 1-800-UNILOCK

**UNILOCK<sup>®</sup>**  
PAVERS & WALLS