

DURA HOLD 2[®]

600 X 600 CB BEHIND WALL

REF: Detail_DuraHold2_Catch Basin Behind Wall

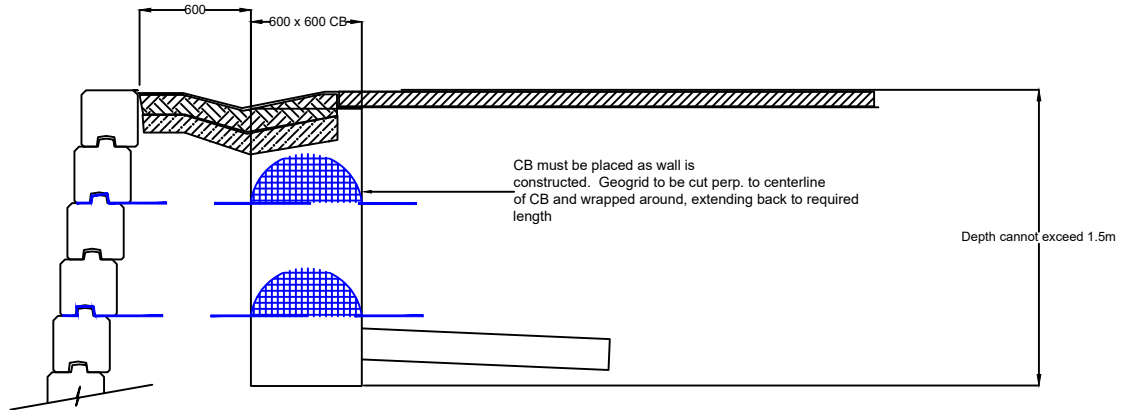

PLAN VIEW

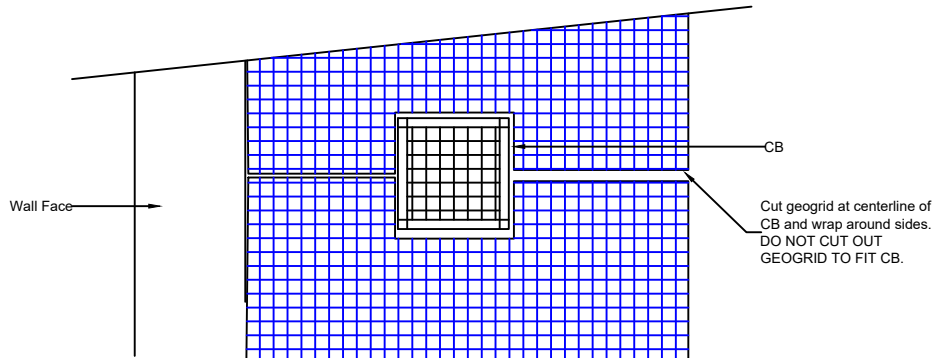

Note:

1. Civil Engineer must review detail for CB.
2. Generally, Catch Basins and other structures should be located outside of the reinforced zone of the wall. If this is not possible, care must be taken to ensure the system is sealed and not susceptible to leakage. Conduits carrying fluids under pressure can not be located within the reinforced zone of the wall.
3. Geogrid must be wrapped around the sides of the CB as it is installed to ensure equivalent area of geogrid.



Engineering design by RisiStone Inc.



UNILOCK.COM | 1-800-UNILOCK