

PISA2[®] / ROMAN PISA[®]

REF: Detail_Pisa2_Roman Pisa_Post and Beam Traffic Barrier on Top of Gravity Wall

GRAVITY WALL W/ FLEXIBLE POST AND BEAM TRAFFIC BARRIER

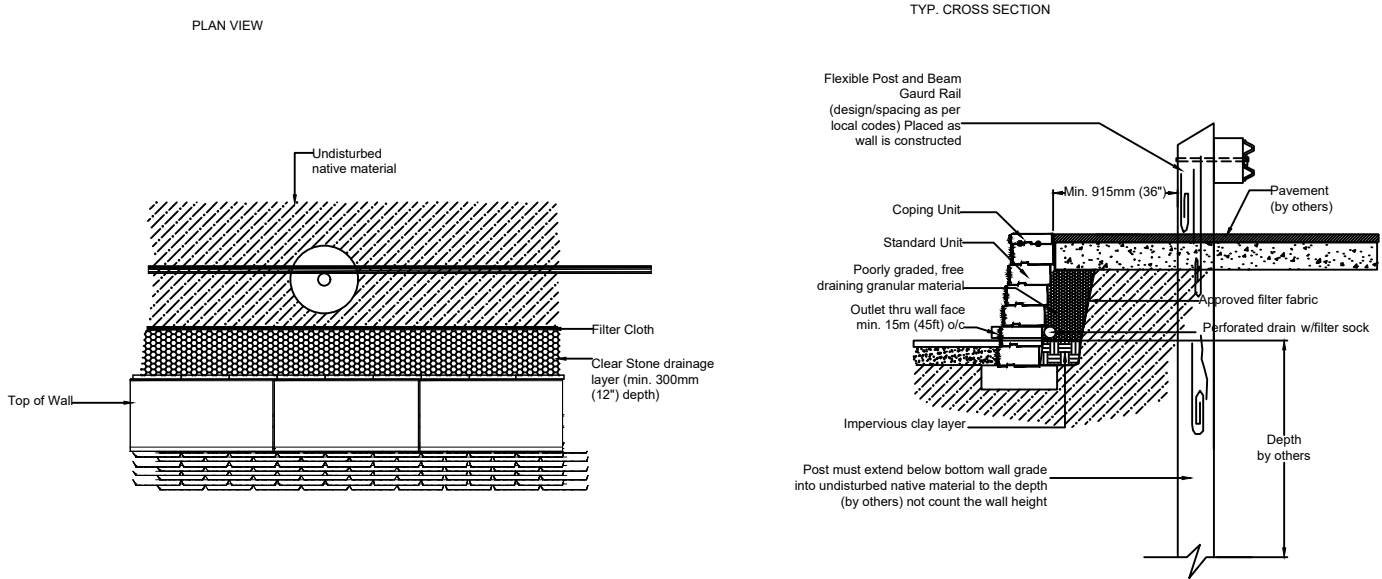

Notes

1. Post must extend below bottom wall grade into undisturbed native material to the depth (by others) not count the wall height
2. Post must be placed as retaining wall is constructed.



Engineering design by RisiStone Inc.

UNILOCK.COM | 1-800-UNILOCK

UNILOCK[®]
PAVERS & WALLS