

PISA2[®] / ROMAN PISA[®]

REF: Detail_Pisa2_Roman Pisa_Flexible Post and Beam Traffic Barrier on Top of Grid Wall

W/ FLEXIBLE POST AND BEAM TRAFFIC BARRIER

PLAN VIEW

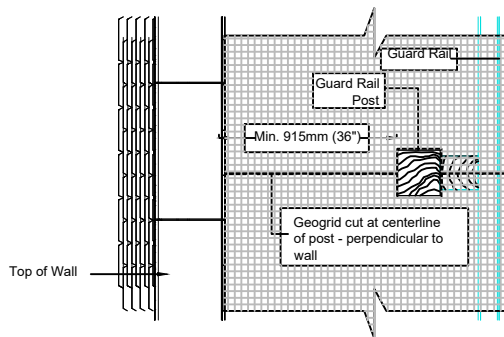

TYP. CROSS SECTION

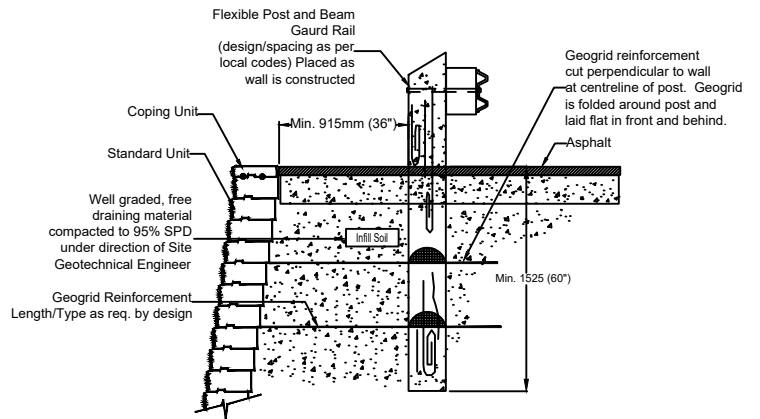

Note:
Wall must be designed to include the effects of guardrail by a qualified professional Engineer.

Notes

1. Guardrail posts to extend a minimum of 1525mm (60") below grade.
2. Posts must be placed as retaining wall is constructed.
3. Geogrid reinforcement to be cut perpendicular to wall face at centreline of sonotubes.



Engineering design by RisiStone Inc.

