

# PISA2<sup>®</sup> / ROMAN PISA<sup>®</sup>

## DRAIN AT BASE OF WALL

REF: Detail\_Pisa2\_Roman Pisa\_Drain at Base of Wall

### Elevation

Case 1 - Flat grade along wall length: Create 2% slope to outlets as shown.

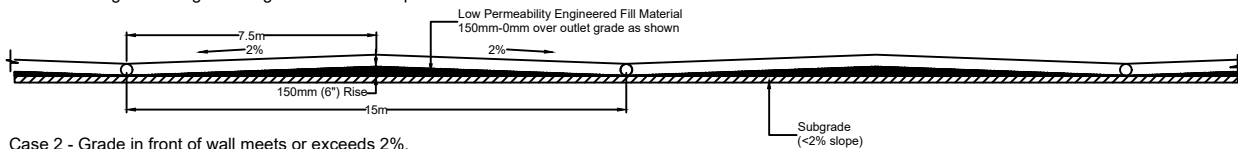

Case 2 - Grade in front of wall meets or exceeds 2%.

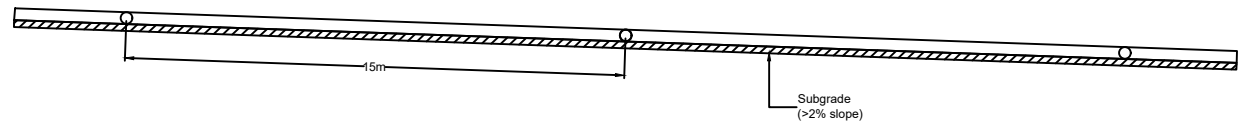

### Typ. Section

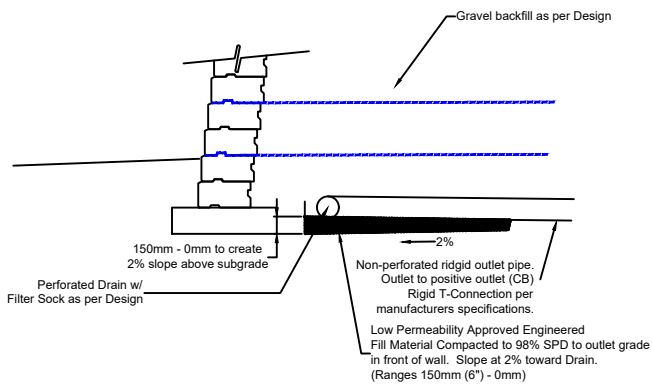

### Face View (Enlarged)

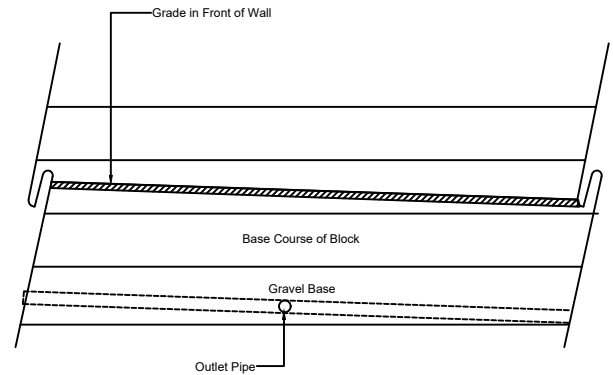

Engineering design by RisiStone Inc.



UNILOCK.COM | 1-800-UNILOCK