

# HOW-TO **BUILD**

## OUTDOOR KITCHEN



**UNILOCK**

# HOW-TO BUILD

## OUTDOOR KITCHEN

There are **THREE** ways to build an outdoor kitchen.



### TRADITIONAL GRILL ISLAND CONSTRUCTION

Build using Unilock wall blocks.



### U-CARA MODULAR SYSTEM

Build with Fascia panel on Unilock modular aluminum frame system.



### U-CARA WALL MOUNT SYSTEM

Build your own custom cabinet and mount U-Cara® panels to the face using the U-Cara Wall Mount System.



This guide will take you through the **TRADITIONAL GRILL ISLAND CONSTRUCTION** method which will allow you to construct a grill island with several wall systems from Unilock.

The instructions in this guide are based upon Unilock Brussels Dimensional™, but can be applied to several Unilock wall systems such as Lineo™, Pisa2™, Concord Wall™, Olde Quarry™, and Estate Wall™.

The key is to use a wall system that is no more than 9 or 10" deep (front to back) so that there is minimal loss of internal space.

# HOW-TO **BUILD**

## **OUTDOOR KITCHEN**

➤	Tools and Equipment .....	4
	Construction Supplies .....	5
	Before Starting .....	6
	Planning the Size .....	7
	Planning Utilities .....	8
	Forming and Pouring the Base Pad .....	9
	Installing the First Row .....	10
	Installing the Second Row and Corners .....	11
	Installing a Foot Rest/Accent .....	12
	Appliance Templates .....	13
	Fourth Row .....	14
	Installing Subsequent Rows (5-7) .....	15
	Using Lintels to Support Appliances .....	16 - 17
	Installing the Final Rows (8-9) .....	18
	Installing the Countertop .....	19
	Bar Counter Extension .....	20
	Adding a Backsplash .....	21
	Installing Backsplash Coping .....	22
	Installing the Appliances .....	23

# HOW-TO BUILD

## OUTDOOR KITCHEN

### Tools and Equipment



Rubber Mallet



Tape Measure

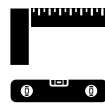

Square and Level



Caulking Gun



Shovel



Rake



Screeding Bar



Fluorescent String Line



Wheelbarrow



Post hole auger



Mini Excavator (Optional)



Circular Saw



Laser Level



Impact Compactor



Concrete Mixer (Optional)



Masonry Saw



Vibratory Compactor

# HOW-TO BUILD

## OUTDOOR KITCHEN

### Construction Supplies



Unilock Wall  
Block



Sonotubes  
(42" Long x 8" Diameter)



½" Rebar for  
reinforcement



Redi-Mix  
concrete /  
bagged  
concrete mix



2 x 6 Framing  
Lumber and  
Stakes



Duct Tape



Aluminum  
2 x 2 Angle  
(⅛" or ¼" lintel)



Concrete  
Adhesive

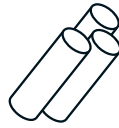

Utility  
Conduit

# HOW-TO BUILD

## OUTDOOR KITCHEN

### Before Starting

Pre-ordering components and arranging required technicians early will help your project go smoothly

### CHECKLIST

- Choose and order Unilock Wall Product
- Draw a basic design indicating position of all components
- Order your grill head and components
- Pre-arrange licensed gas fitter, electrician and plumber
- Decide on a counter-top product and incorporate into estimated timeline
- Arrange a utilities "locate" before excavation

Plumbing Hardware



Access Doors



Bar Fridge



Drawers



Grill Head

# HOW-TO BUILD

## OUTDOOR KITCHEN

### Planning the Size

Once you've selected a Unilock product, reduce cutting by using the unit dimensions to determine the optimal size for your island.

**Proper size planning can reduce cutting by up to 90%.**

Plot your design on a computer or graph paper to fine tune the dimensions prior to building the foundation.

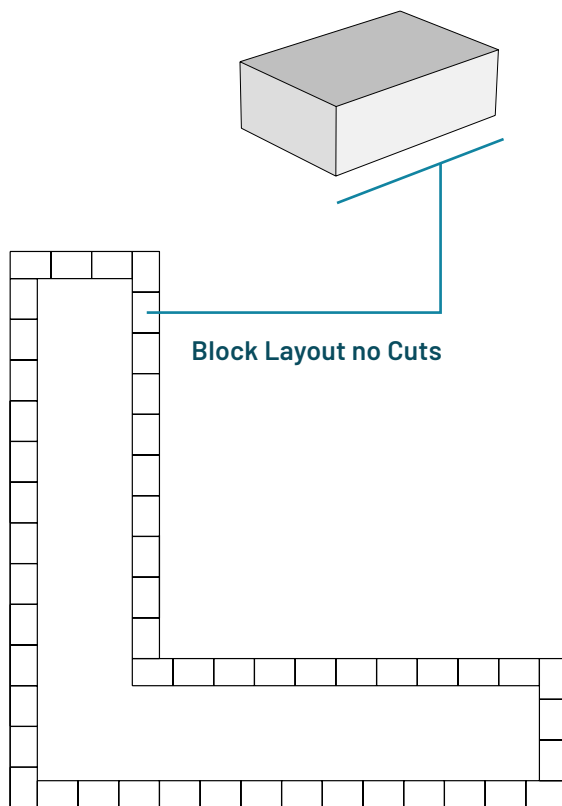

# HOW-TO BUILD

## OUTDOOR KITCHEN

### Planning Utilities

Once you've selected a Unilock product, you can begin to plan out the size and layout of the island. Consider where utilities will run to and from before you begin excavation.

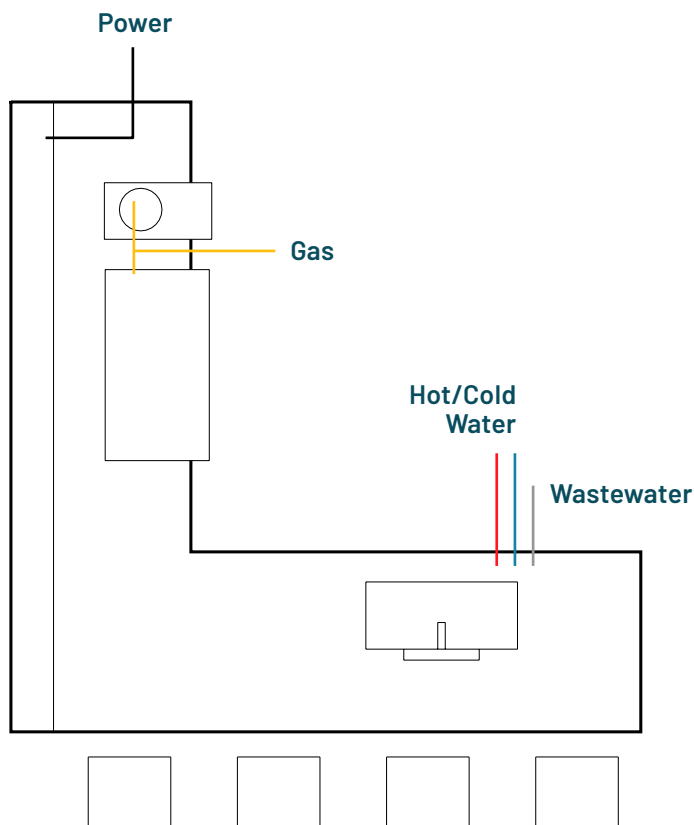

**NOTE:** All utilities must be in appropriate conduits and buried as per your local building codes.

# HOW-TO BUILD

## OUTDOOR KITCHEN

### Forming and Pouring the Base Pad

#### STEP 01

Excavate and fill area with compacted free-draining gravel (min 6" below bottom of pad).

#### STEP 02

Install utility conduits to approximate location in island.

#### STEP 03

Build a form with 2 x 6 lumber using the wall unit sizes to determine the optimal size. Be sure to position the form precisely, perpendicular or parallel to the house, or in accordance with your overall project plan. The form must be perfectly level.

#### STEP 04

Construct pad on concrete supports (Sonotubes®).

#### STEP 05

Construct the base pad on concrete supports (Sonotubes) and create reinforcements with rebar and/or mesh.

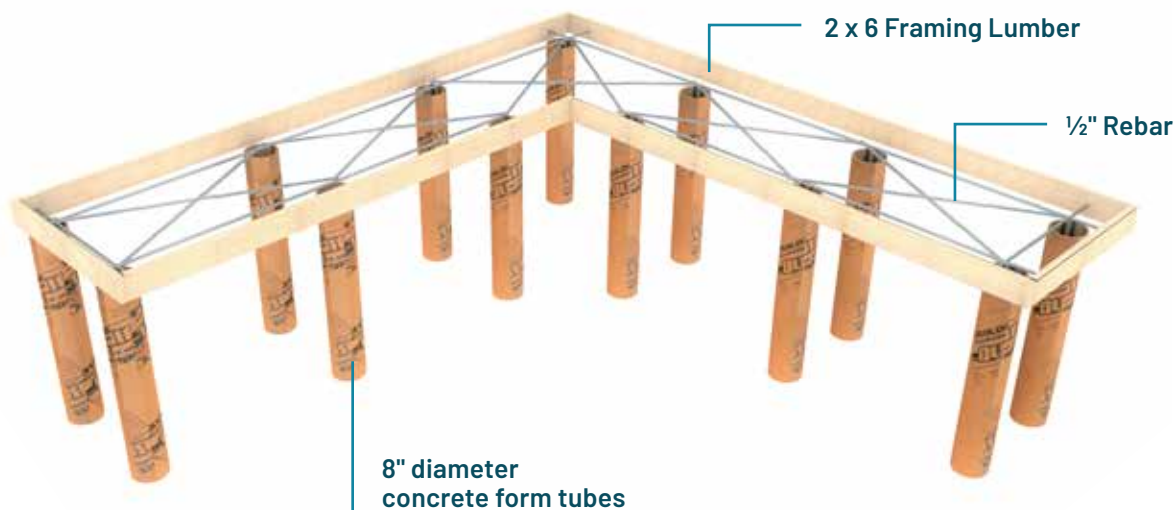

# HOW-TO BUILD

## OUTDOOR KITCHEN

### Installing the First Row

Concrete must be cured for at least 72 hours before starting construction.

#### STEP 01

Unpackage all grill island components to ensure the correct item and size was delivered.

#### STEP 02

Apply two ¼" beads of concrete adhesive between blocks and base pad.

#### STEP 03

While placing your first row of units around perimeter, leave any appliance openings as per your plan.

#### STEP 04

Use a string line or aluminum screeding bar to maintain alignment and square.

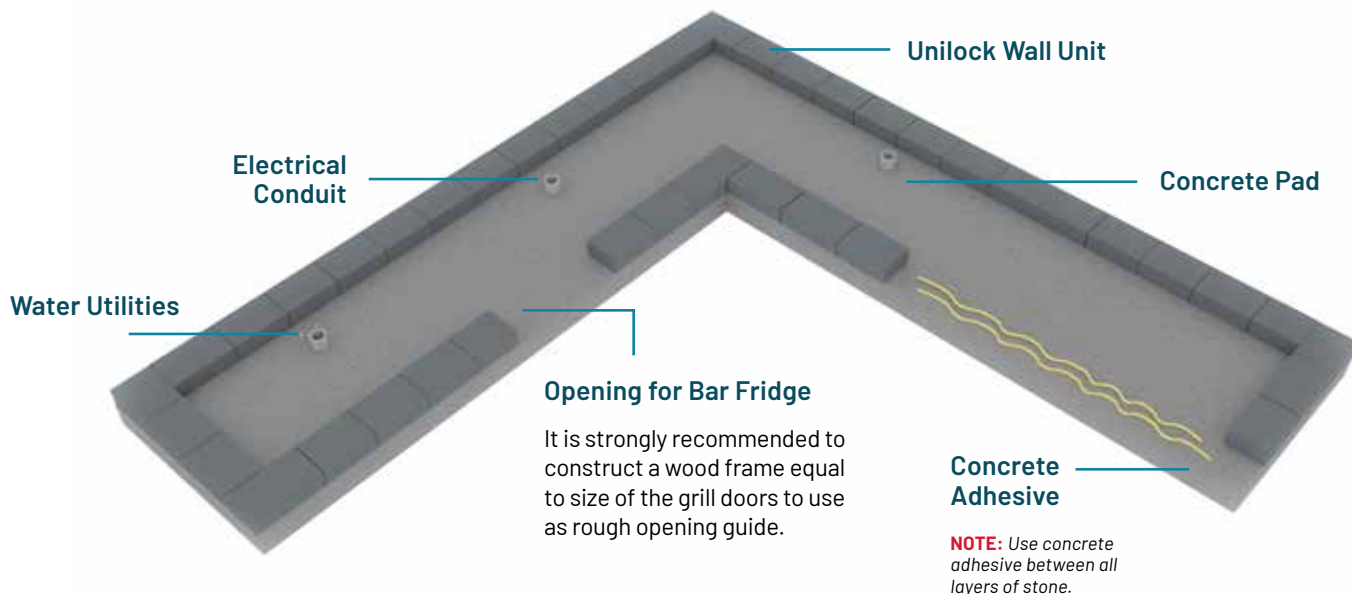

# HOW-TO BUILD

## OUTDOOR KITCHEN

### Installing the Second Row and Corners

#### STEP 01

Installing the second row is much the same as the first row except that you will "lap" or "log cabin" the inside and outside corners as shown below.

#### STEP 02

Always use adhesive between every row of units. Using your carpenter's square, level, tape measure and screeding bar, carefully ensure that all units are in both vertical and horizontal alignment with the first row before the adhesive sets.

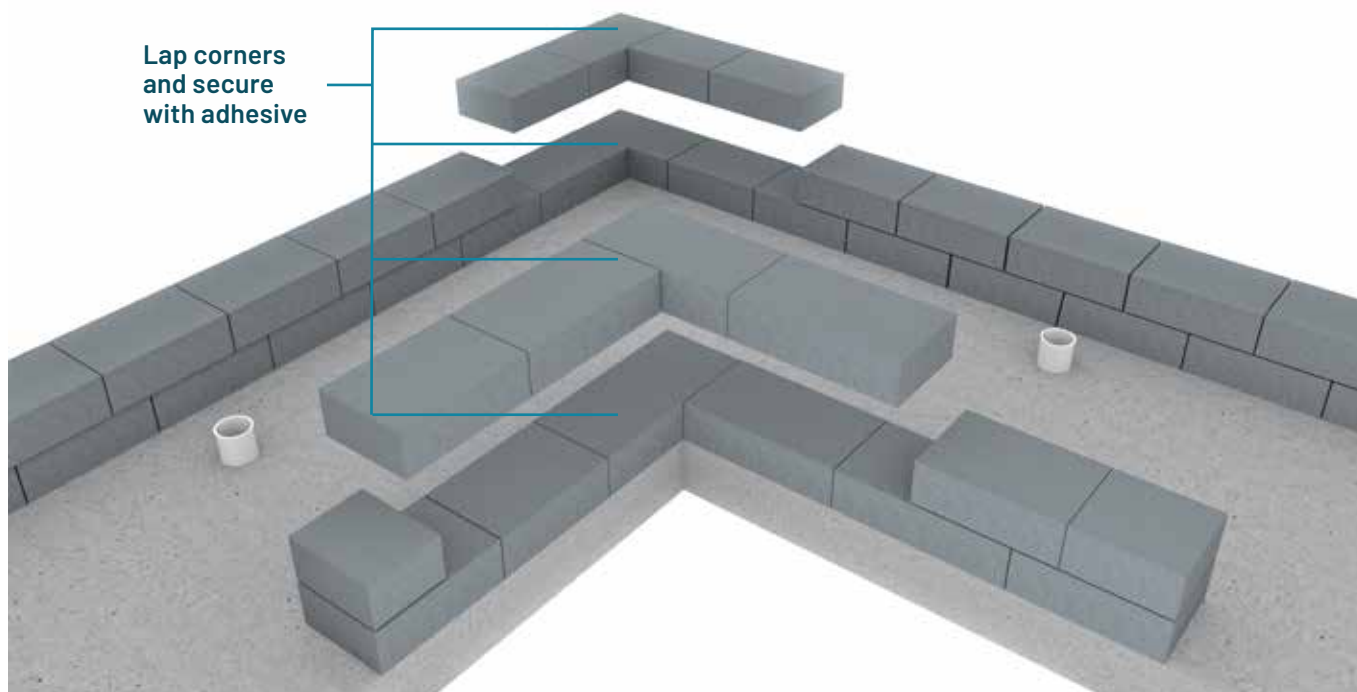

**NOTE:** Use concrete adhesive between all layers of stone.

# HOW-TO BUILD

## OUTDOOR KITCHEN

### Installing a Foot Rest/Accent

#### STEP 01

Determine which course is appropriate for the foot rest in order to optimize comfort and visual appeal. Typically this is the third or fourth course, depending on product unit heights.

#### STEP 02

In this illustration, the foot rest is made from a thinner material such as coping. Coping should overhang approximately 2" beyond the face of the island.

2" Overhang  
Recommended



#### Foot Rest (Optional)

A foot rest is recommended for comfort and overall appearance. Consider using a different color and/or texture as an accent.

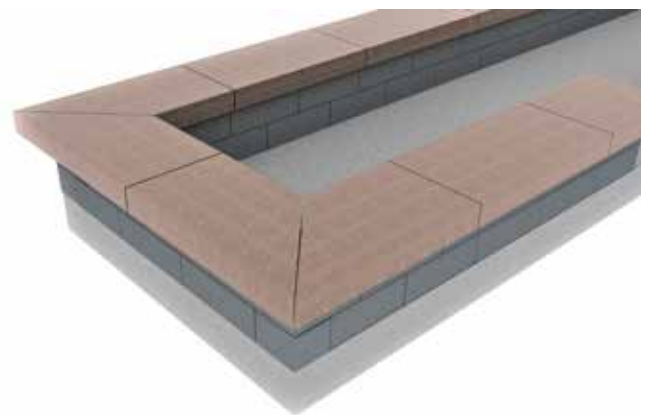

# HOW-TO BUILD

## OUTDOOR KITCHEN

### Appliance Template

Create appliance templates using 2 x 4 lumber to use as a fitting guide while constructing the island to protect appliances from damage during construction.

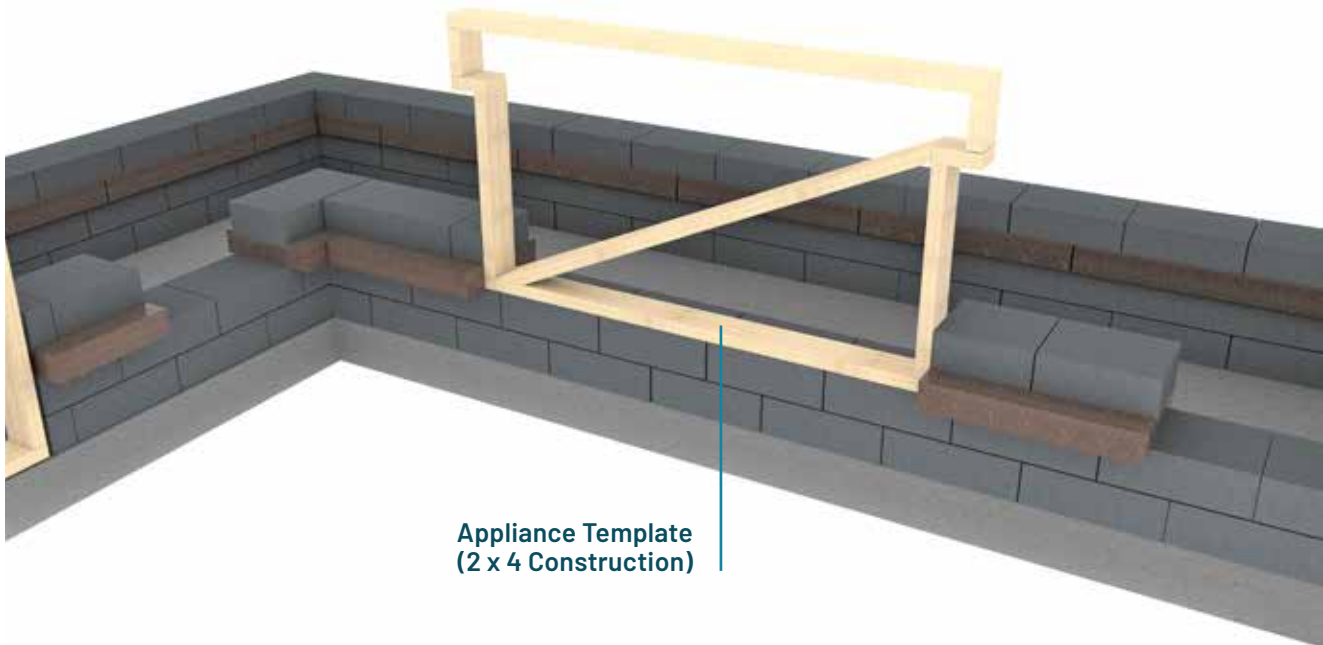

Appliance Template  
(2 x 4 Construction)

# HOW-TO BUILD

## OUTDOOR KITCHEN

### Fourth Row

#### STEP 01

Ensure the adhesive on previous rows is completely set/cured. You may need to pause between rows to ensure this is the case. Do not begin this row before the previous rows are set.

#### STEP 02

Resume the bond offset that was established in the first two rows when placing this row, for a pleasing appearance.

#### STEP 03

Double and triple check units to ensure they have not gone out of alignment before the adhesive sets. Keep corners and small pieces in place using duct tape if required.

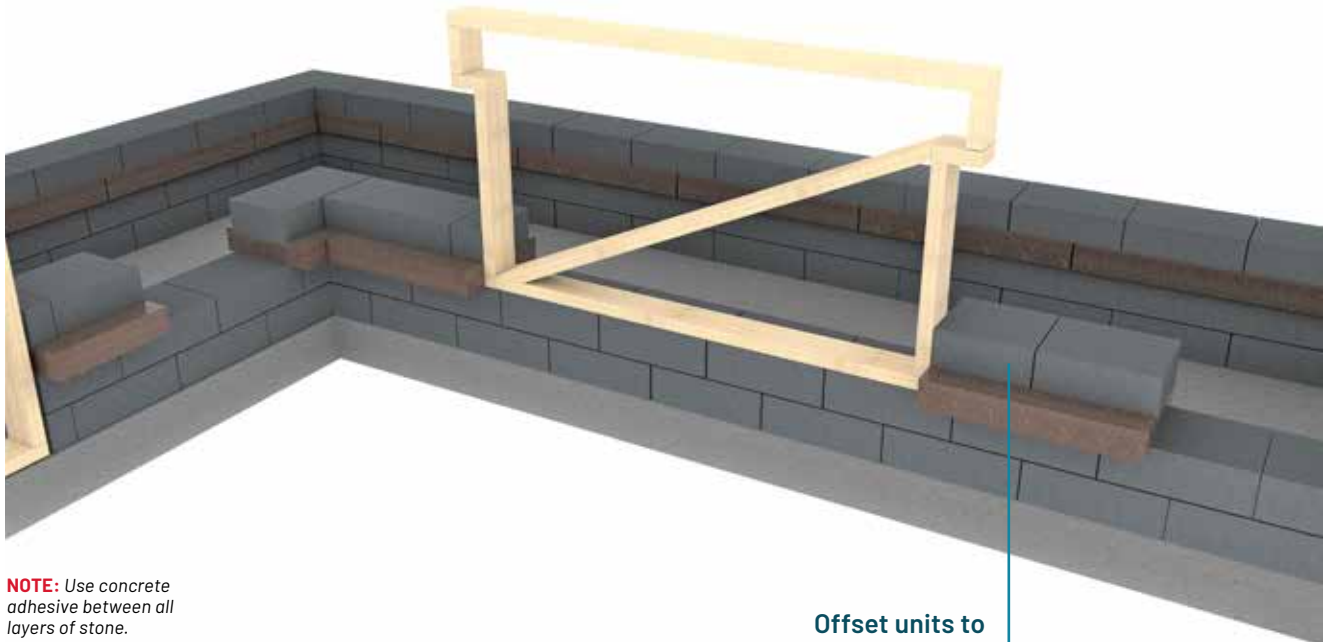

**NOTE:** Use concrete adhesive between all layers of stone.

Offset units to coincide with Row 1

# HOW-TO BUILD

## OUTDOOR KITCHEN

### Installing Subsequent Rows (5-7)

#### STEP 01

Once the glue has set, you can continue with rows 5, 6, and 7 making sure that the glue sets between rows.

#### STEP 02

Be sure to double and triple check as you build that the horizontal and vertical alignment has not shifted.

#### STEP 03

Use the appliance template to help you stay on track with size and position. Remove the template as needed when installing the lintels.

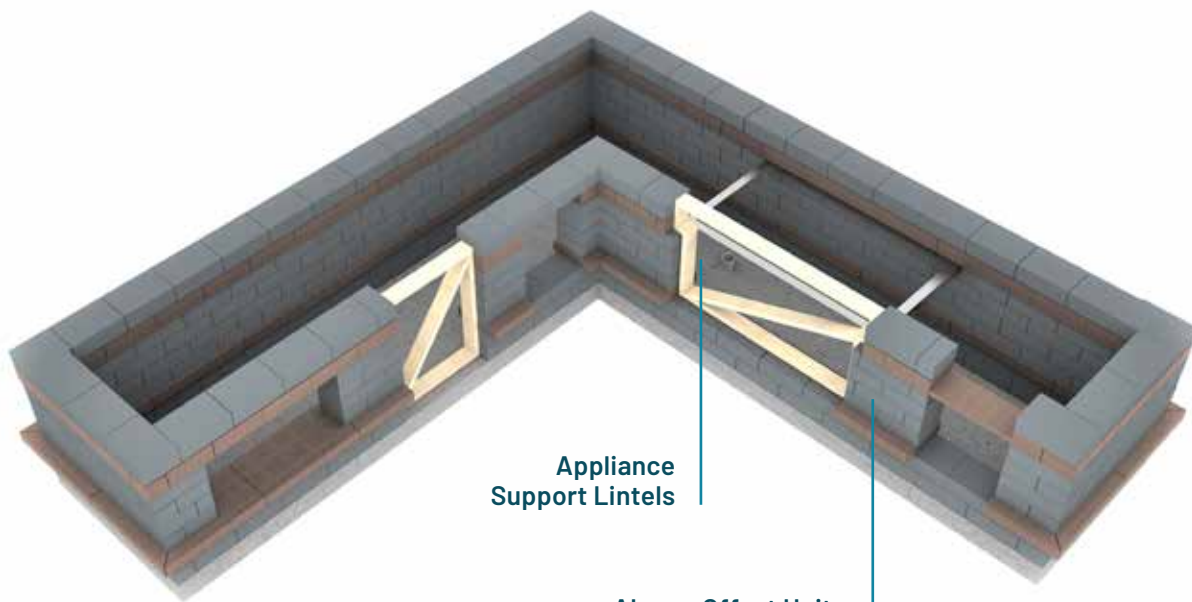

**NOTE:** Use concrete adhesive between all layers of stone.

# HOW-TO BUILD

## OUTDOOR KITCHEN

### Using Lintels to Support Appliances

#### STEP 01

Always follow the appliance manufacturer's recommendations for bracing and supporting the appliances.

#### STEP 02

Bracing should be done with Aluminum lintels. Steel can be used, but over time it can rust and sometimes bleed through the face.

#### STEP 03

To ensure the lintels sit flush, notching of the wall units may be required. A small grinder is best for this. Glue the lintels in place with concrete adhesive.

Notch out units for Lintels

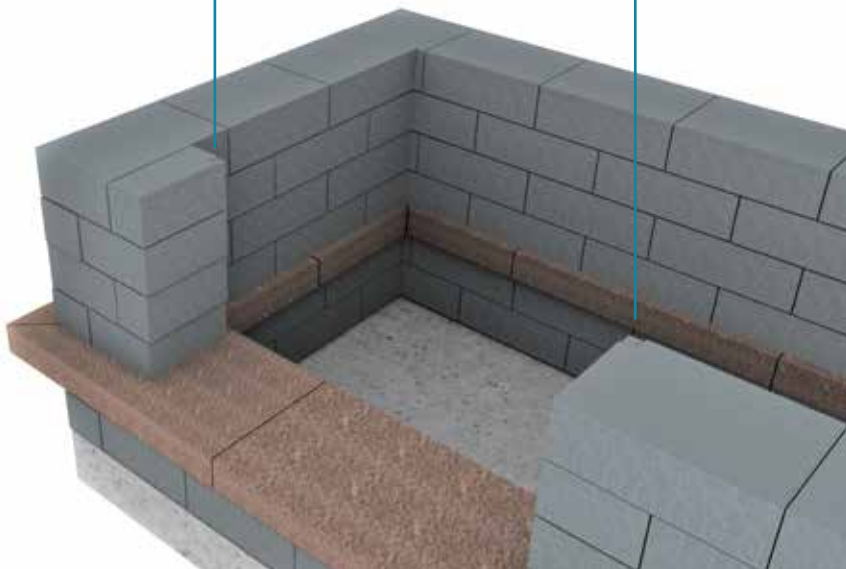

Secure Lintels in with concrete adhesive

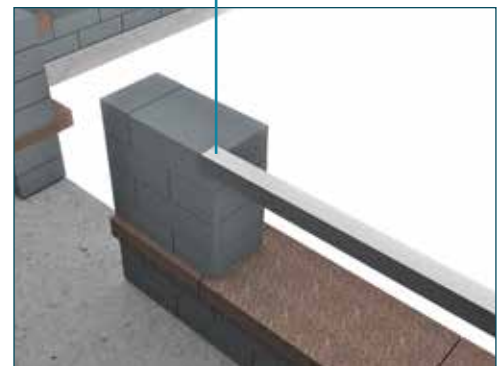

# HOW-TO BUILD

## OUTDOOR KITCHEN

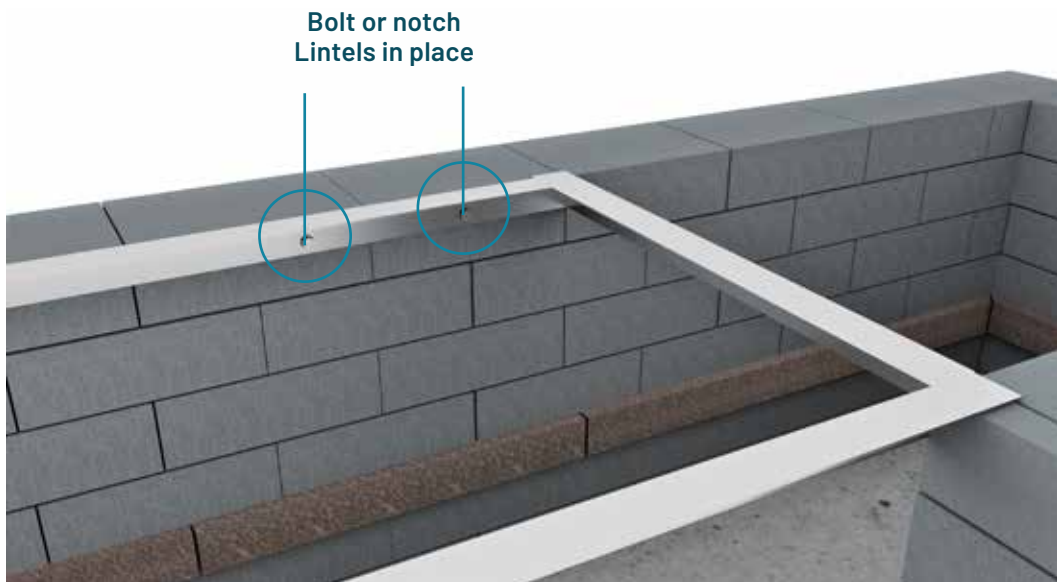
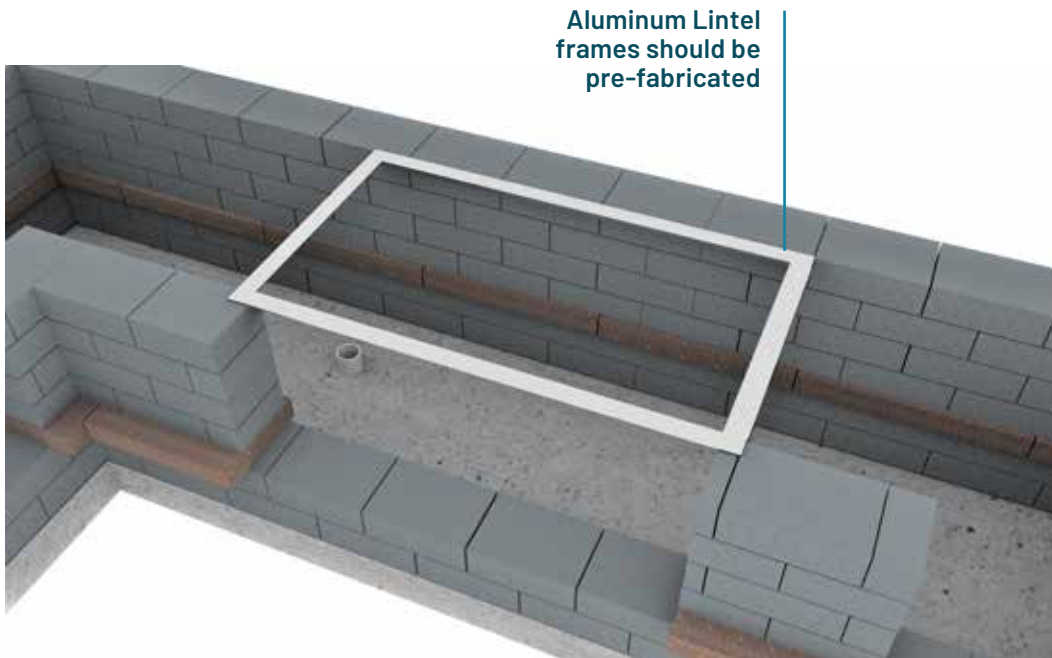

# HOW-TO BUILD

## OUTDOOR KITCHEN

### Installing the Final Rows (8-9)

The final rows present an opportunity to introduce a contrasting color or texture by inserting a row of accent pavers or using a different color of the wall product you have chosen.

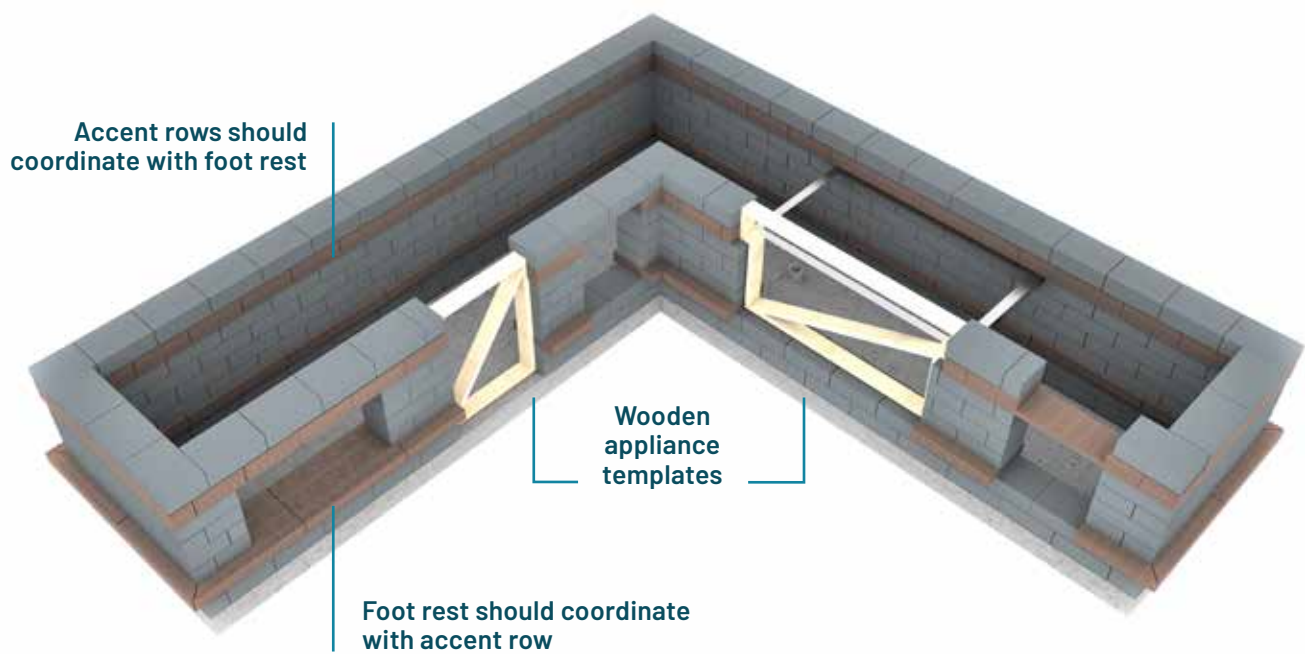

# HOW-TO BUILD

## OUTDOOR KITCHEN

### Installing the Countertop

When planning a countertop, ensure that it extends 2" beyond the face of the island. To accommodate seating on the bar side of a counter, increase this to 12" from the face of the island.

Your countertop manufacturer will provide guidance regarding segmentation and electrical ports can be drilled after the counter is in place.

Poured concrete can be constructed on site but should contain expansion joints.

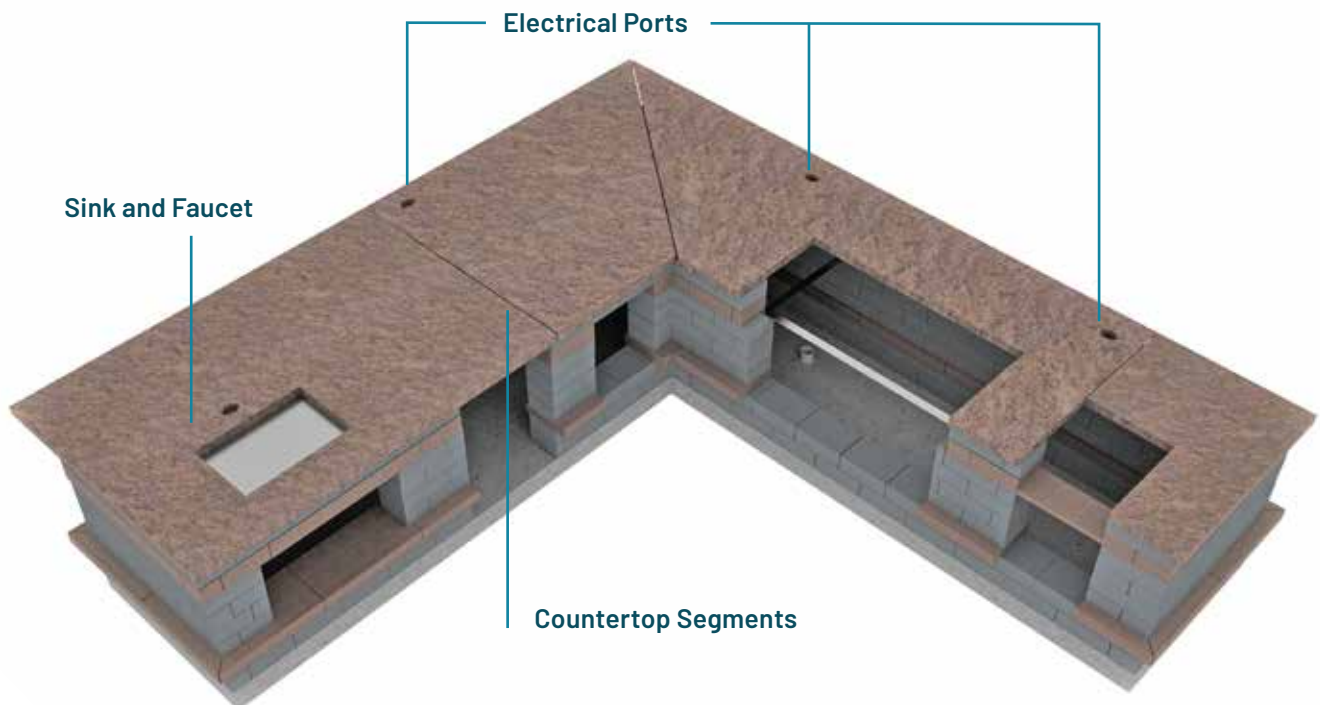

# HOW-TO **BUILD**

## **OUTDOOR KITCHEN**

### **Bracing the Bar Counter Extension**

Your countertop manufacturer can advise how many braces are required and the best materials and fasteners to use based on your design. Never use steel as it will rust and negatively impact the appearance of your project over time. However, regardless of the materials used, it is not recommended to extend a counter beyond 12" from the face of the island.

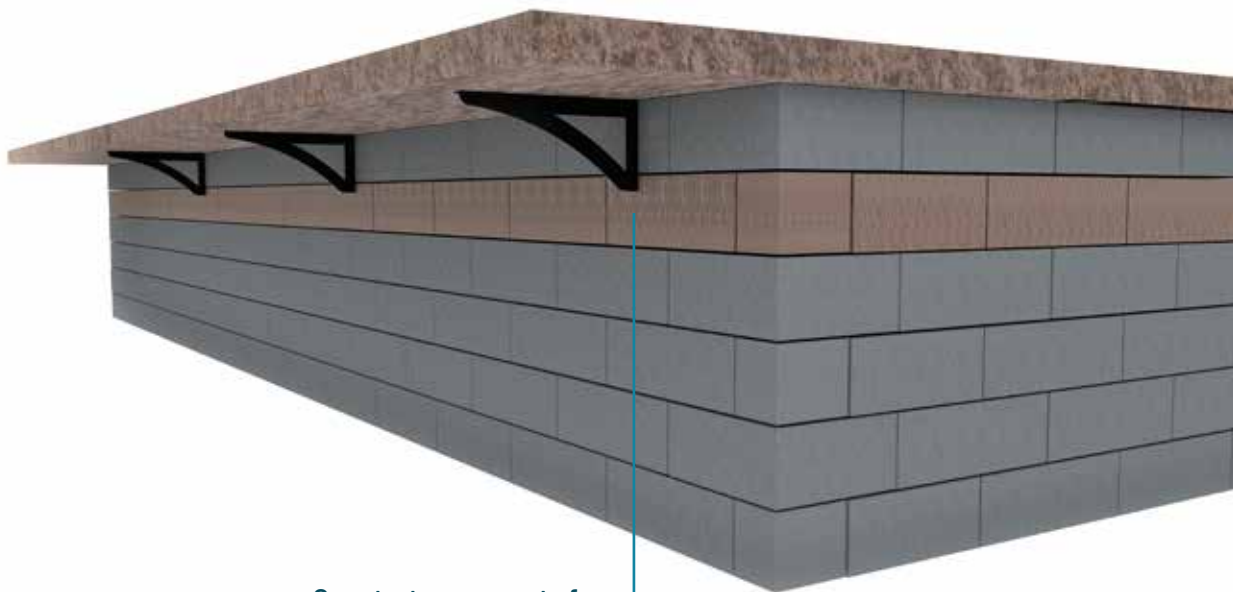

Countertop supports for  
bar extension

# HOW-TO BUILD

## OUTDOOR KITCHEN

### Adding a Backsplash

#### STEP 01

Minimal glue is required to adhere row 1 of the backsplash to the countertop. The maximum height of a backsplash is 10-12" and it is often constructed using the same material as the rest of the island.

#### STEP 02

Several blocks may be notched to accommodate a recessed receptacle and provision for electrical can be made by drilling through the counter. However, surface mounting receptacles is often an easier option.

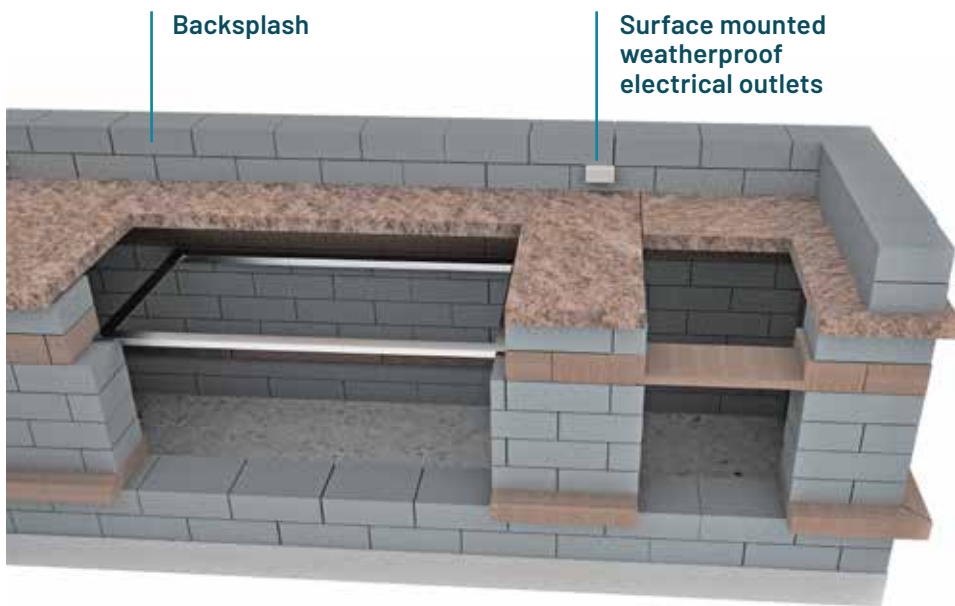

# HOW-TO BUILD

## OUTDOOR KITCHEN

### Installing Backsplash Coping

#### STEP 01

Using the same material as the countertop looks the best.

#### STEP 02

Adhere using concrete adhesive.

#### STEP 03

Add under countertop and backsplash coping lighting if desired. Drill holes through the countertop and blocks to run low voltage wiring and adhere LED lights.



# HOW-TO BUILD

## OUTDOOR KITCHEN

### Installing the Appliances

#### STEP 01

Install all appliances in accordance to manufacturer's requirements. Always observe local building codes.

#### STEP 02

Access doors and drawers may require drilling for screws into the concrete into the concrete to secure the unit.

#### STEP 03

Install the bar fridge last, as this is typically the easiest item to install and can provide you access to other hookups.



# HOW-TO **BUILD**

## **OUTDOOR KITCHEN**

**Congratulations - your outdoor kitchen is complete!**

For more help designing and building outdoor kitchens, contact your local Unilock Territory Manager (1-800-UNILOCK) to arrange a phone consultation or site visit.



Completed Grill  
Island and Bar

## Hardscape Education Center

### Looking for more product specific information?

The **Unilock Hardscape Education Center** contains a robust library of **over 1,500...**

- › Cross Sections
- › Instructional Videos
- › Seminar Recordings
- › Catalog Downloads
- › Certificate Courses

You can access all this and more in the contractor section of **Unilock.com**.

